

Wireless **LOAD SENSE** Load Sensor

The wireless **LOAD SENSE** Load Sensor is a strain gauge based stainless steel tension type sensor. It has the capability of wirelessly transmitting its data to one of our compatible readouts and displays or recording its data locally. Its inbuilt 32MBit memory can hold up to 149 hours of data which can then be downloaded to a PC via its USB cable. The Load Sensor transmits using the worldwide licence free frequency of 2.4Ghz on two built in antennas.

The **LOAD SENSE** Load Sensor is used with our HandHeld Receiver which can read several devices at the same time, (see data sheet WLS3626R for more details), and/or our stand alone Receiver Interface which is used to output the data via RS232/RS422, (see data sheet WLS3627R for more details)

Benefits

- Wireless, so easy to install and remove between installations
- Transmits data up to a distance of 30M
- Transmits data at up to 10 times a second
- Internal Memory for up to 149 hours of data
- USB or 5V to 28V external supply chargeable
- Connect to PC via USB
- PC software for customer settings
- Flexible automatic shutdown to conserve battery
- Dual ruggedised internal antennas

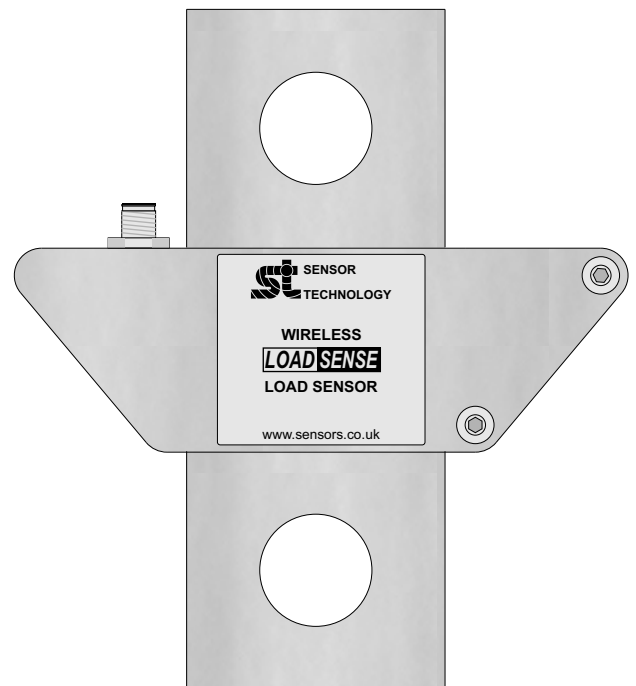

Technology

The **LOAD SENSE** Load Sensor works in the worldwide harmonized band of 2.4 GHz so does not require a licence to operate and uses advanced technologies to enable data to be sent and received error free, these include, forward error correcting and data whitening.

Technical Data

Nominal Load	1, 3, 5, 10 Ton
Accuracy	± 0.25%
Max Overload	150%
Breaking Load	> 300%
Temp Coef of Zero	0.05% Deg C
Temp Coef of Span	± 0.01% Deg C

Environmental Protection	IP65
Weight	5 Kg
Materials	Stainless Steel / Aluminium
Operating Temp Range	-10°C to + 50°C
Storage Temp Range	-20°C to + 60°C
Internal memory	32 Mbit

RF

Transmitter Output Power EIRP	+10 dBm		
Frequency Range	2425 - 2430 MHz	20 Channels	250kHz steps
Modulation	MSK		
Data Rate	250Kbps		
Antenna	Dual patch antennas		
RFI / EMC	To EN301-489 1, FCC Part 15 pending		

Power Input

Battery

Type	Li-Ion Varta LIC18650
Voltage	3.7V 2200mAH
Data transmit rate	Operating time at 20°C
1 / Sec	1000 Hours +
10 / Sec	120 Hours

Charge Facilities

Connector	USB	External Power
Voltage	5V	5V - 28V
Charge time (from complete discharge)	33 hours	3 hours

Lead for USB charging, data transfer and external power input is provided.

Mechanical Data

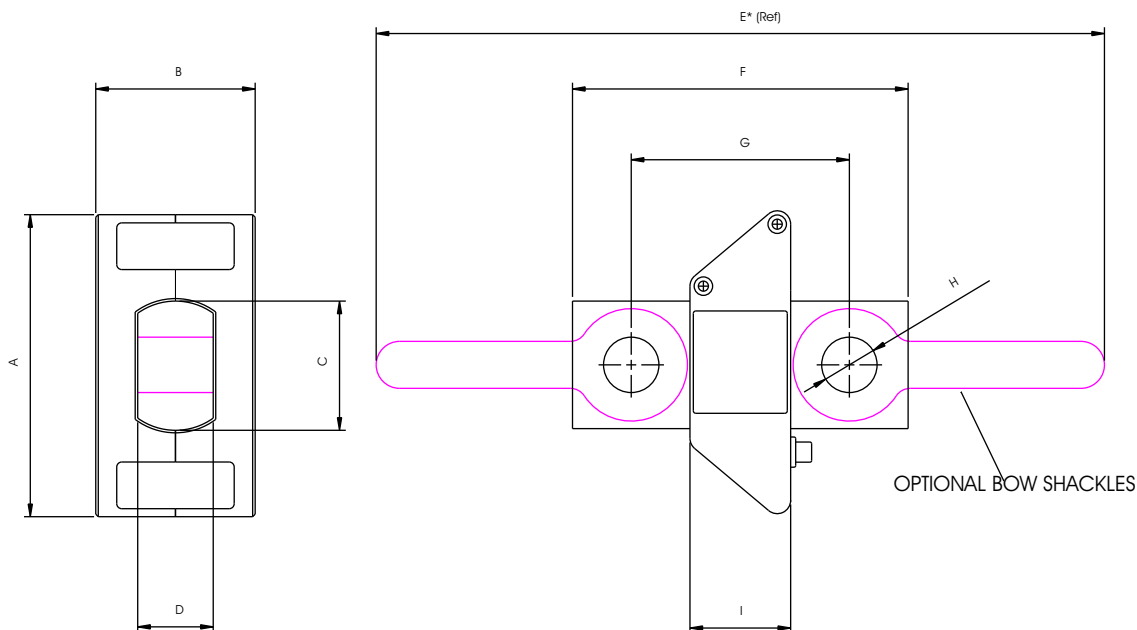

FSD	A	B	C	D	F	G	H	I
1 Ton	180.00	95.00	76.00	45.00	200.00	130.00	33.00	60.00
3 Ton	180.00	95.00	76.00	45.00	200.00	130.00	33.00	60.00
5 Ton	180.00	95.00	76.00	45.00	200.00	130.00	33.00	60.00
10 Ton	180.00	95.00	76.00	45.00	200.00	130.00	33.00	60.00

E* Length is dependant on shackle used

Sensor Technology Ltd reserves the right to change specification and dimensions without notice.